

EAN: 4015474598287
static.hansa.com/02200100



- Accessories
- Upevnění na zeď pro vestavěnou jednotku
- Uzavírací vršek s vřetenovým ventilem
- Tělo baterie z mosazy DZR

Technical data

Flow properties

Flow-rate at 3 bar **30.0 l/min**

Technical properties

DN-size (nominal dimension) **DN15**
 Hot water supply **max. +90°C**
 Working pressure **1-10 bar**
 Connection size **G1/2**

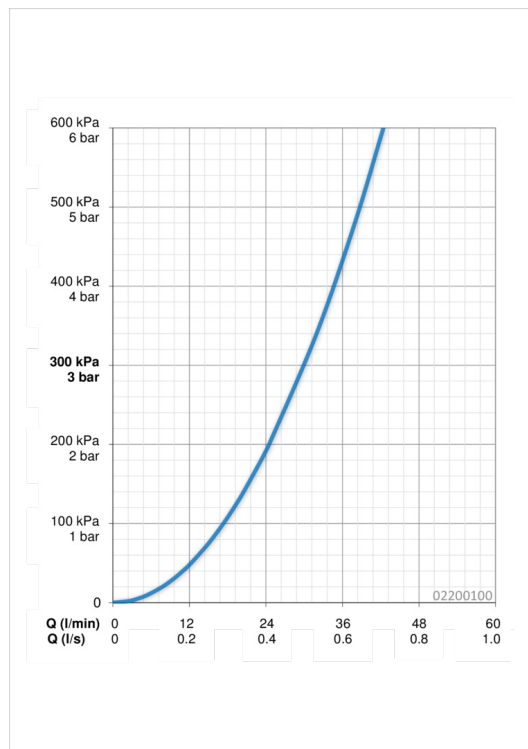

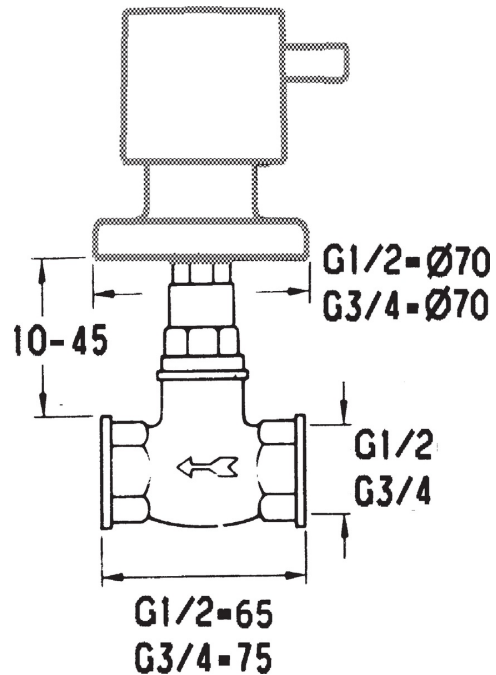
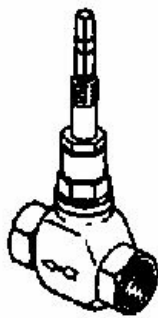

Spare parts

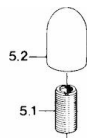
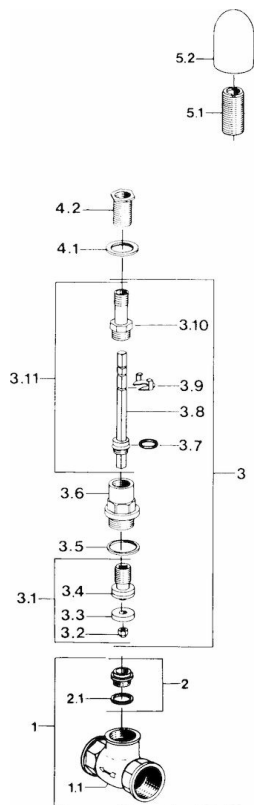

Unterputzventil DN 15 (G 1/2)

mit Gewindeanschluß DN 15

Einbautiefen:

X	von 10 bis 45 mm
	45 bis 80 mm
	80 bis 115 mm

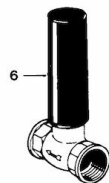

SP02200100

	Name	Code
1	Body	59902011
2	Seat, DN15, R1/2	59904616
2.1	Těsnění, 18,5 x 15 x 1,5	59902314
3	Vršek, 10-45 mm, G1/2	59902723
3	Vršek, 80 - 115 mm, 1/2"	59901451
3	Vršek, 45-80 mm, G1/2	59902726
3.1	Ventilů	59904956
3.10	Závit bradavky	59902620
3.11	Nástavec-sada, L=150	59902701
3.11	Nástavec-sada, 45-80 mm	59905576
3.11	Nástavec-sada, 80-115 mm	59905577
3.3	Těsnicí kroužek	59902301
3.5	Těsnění, 25x21x2	59902319
3.7	O-kroužek, d 9,25 x d 1,78	59902338
3.8	Vřetena, 10 - 45 mm	59902695
3.8	Vřetena, 45 - 80 mm	59902697
3.9	Spring clip	59901017
4.1	Vroubkovaná matice	59902621
4.2	Závit bradavky, M12x1/M15x1, AF17	59902708
5.1	Závit bradavky	59901373
5.2	Shut-off cap	59901106